



AGAVE TRACE

Plan 2110 • 2,110 square feet



ELEVATION A



ELEVATION B



ELEVATION C



TEXAS-HOMES.COM

*These are artist renderings and actual elevation detailing are subject to change.
Refer to Sales Counselor and review actual blueprint. Rev. 09/30/19*



TEXAS HOMES

Texas Built • Texas Owned • Texas Proud



AGAVE TRACE

Plan 2110 • 2,110 square feet

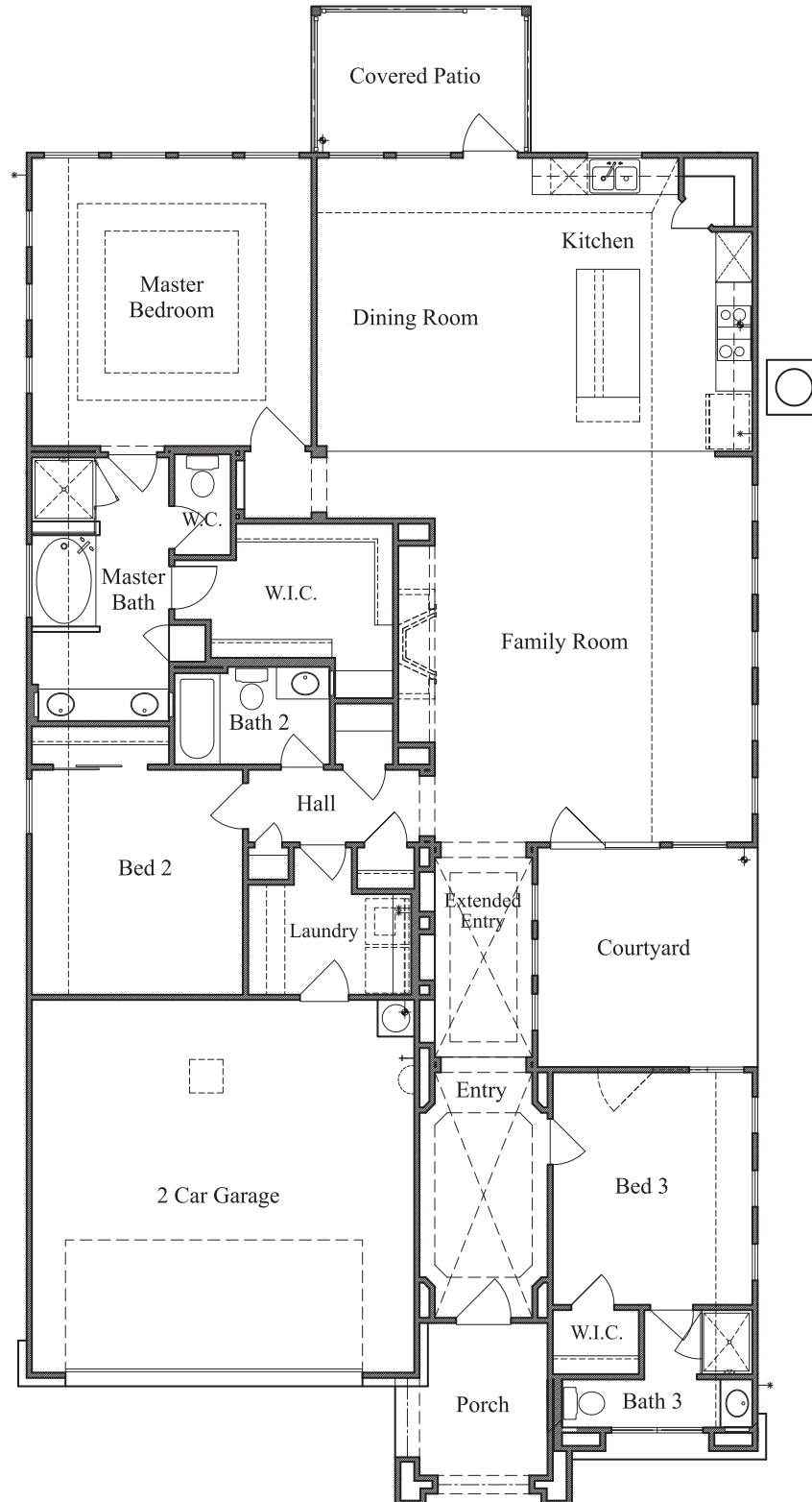

TEXAS-HOMES.COM

Actual room dimensions may vary. See a sales counselor for more information. Rev. 09/30/19



TEXAS HOMES

Texas Built • Texas Owned • Texas Proud



AGAVE TRACE

Plan 2110 • Options

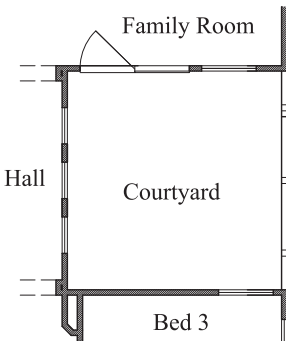
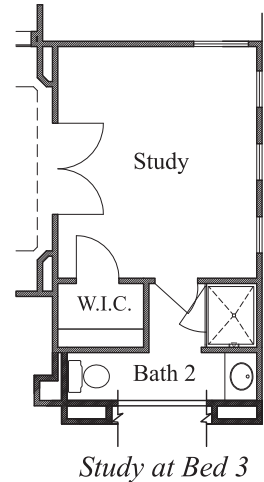
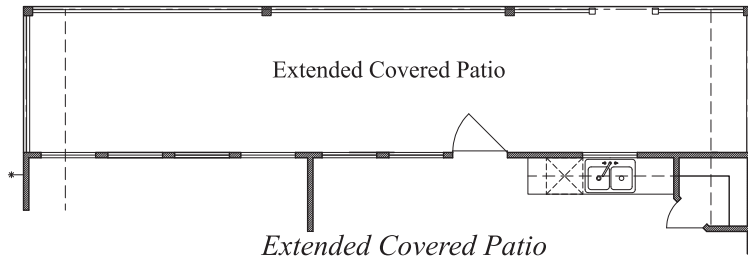

8' Stucco Wall at Courtyard

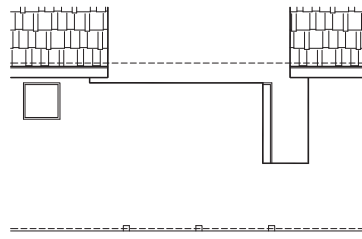

8' Stucco Wall at Courtyard
partial elevation

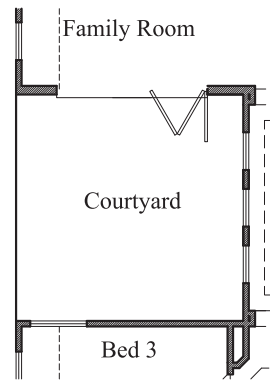

8' Accordion Door
at Family Room

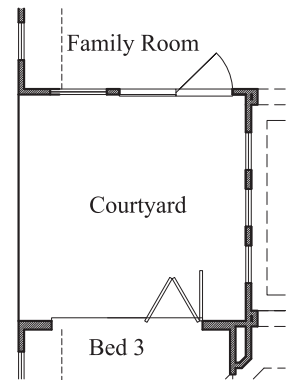

8' Accordion Door
at Study/Bed 3

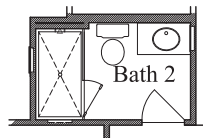

Shower at Bath 2

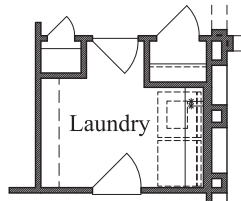

Upper Cabinets
at Laundry

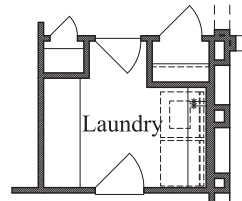

Base Cabinets
at Laundry



Extended Island
at Kitchen

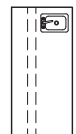

Veggie Sink
at Island

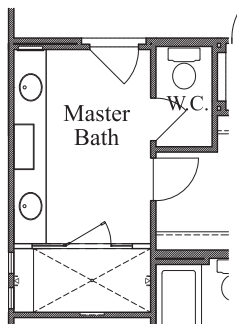

42 x 90" Mudset Shower
at Master Bath

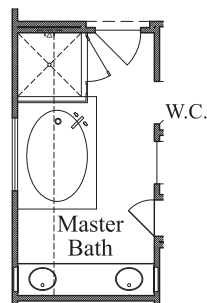

42 x 42" Mudset
Shower with Drop In Tub
at Master Bath

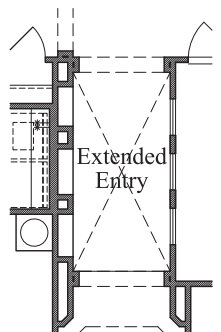

Groin Vault Ceiling
at Extended Entry

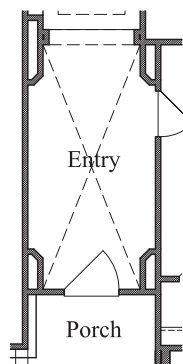

Groin Vault Ceiling
at Entry

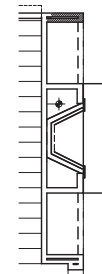

Fireplace at
Family Room



TEXAS-HOMES.COM

Actual room dimensions may vary. See a sales counselor for more information. Rev. 09/30/19



TEXAS HOMES

Texas Built • Texas Owned • Texas Proud