

# PLAN 2110 ~ ELEVATIONS



ELEVATION A



ELEVATION B



ELEVATION C



REV. 08.06.25

Floorplans and elevations are an artist's rendering for illustrative purposes only and may not accurately reflect the construction plans or final product. Texas Homes reserves the right to make changes in the plans, specifications, and to substitute materials of similar quality. Floor plans, dimensions, features, options, elevations, square footages, specifications, materials and availability of homes within a neighborhood are all subject to change without notice or obligation. Prospective buyers should consult with a Texas Homes Sales Counselor for more information.



**TEXAS HOMES**

Texas Built • Texas Owned • Texas Proud

[TEXAS-HOMES.COM](http://TEXAS-HOMES.COM)

# PLAN 2110

2,110 Sq. Ft. | 1 Story | 3 Bedrooms, 3 Baths, 2 Car Garage

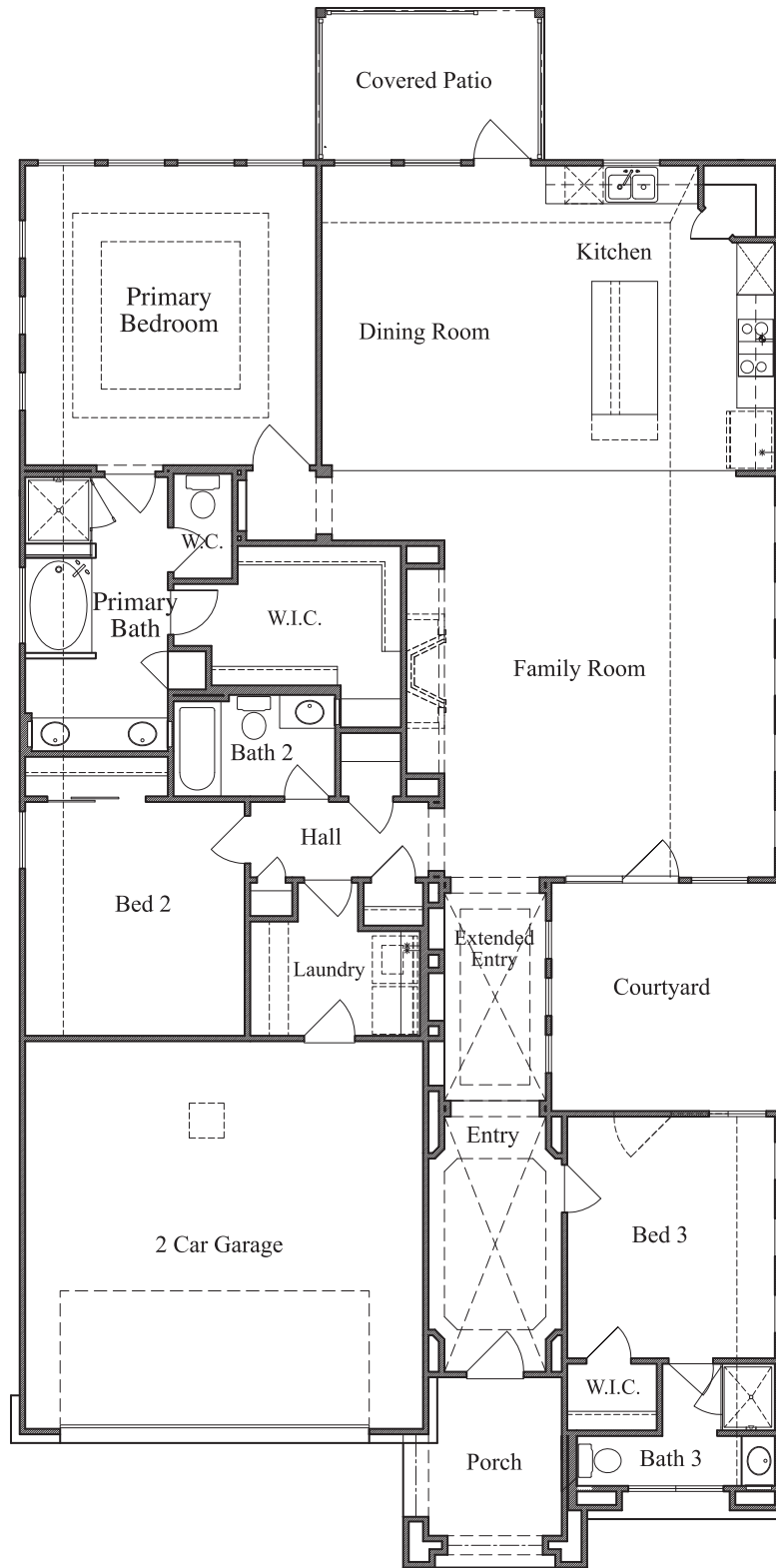

REV. 08.06.25

Floorplans and elevations are an artist's rendering for illustrative purposes only and may not accurately reflect the construction plans or final product. Texas Homes reserves the right to make changes in the plans, specifications, and to substitute materials of similar quality. Floor plans, dimensions, features, options, elevations, square footages, specifications, materials and availability of homes within a neighborhood are all subject to change without notice or obligation. Prospective buyers should consult with a Texas Homes Sales Counselor for more information.



**TEXAS HOMES**

Texas Built • Texas Owned • Texas Proud

[TEXAS-HOMES.COM](http://TEXAS-HOMES.COM)

# PLAN 2110 ~ OPTIONS

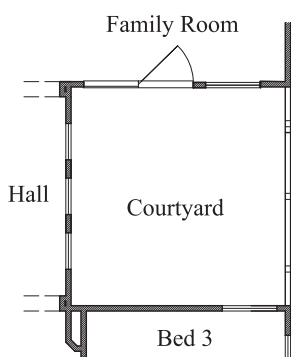
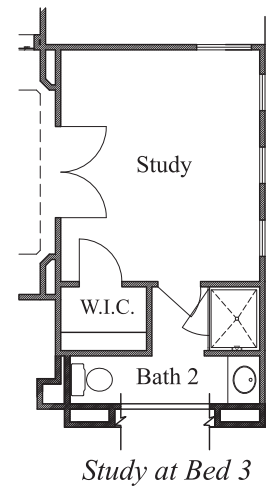
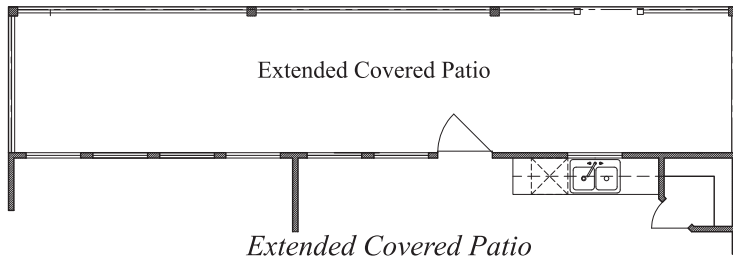

*8' Stucco Wall at Courtyard*

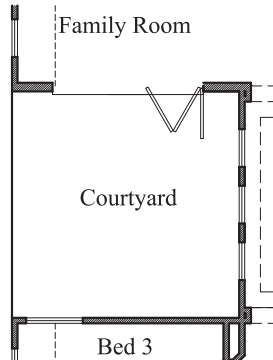

*8' Accordion Door at Family Room*

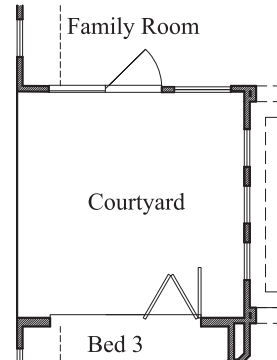

*8' Accordion Door at Study/Bed 3*

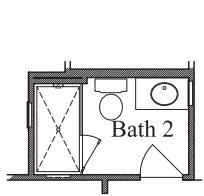

*Shower at Bath 2*

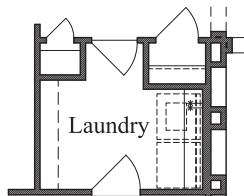

*Upper Cabinets at Laundry*

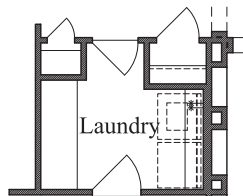

*Base Cabinets at Laundry*



*Extended Island at Kitchen*



*Veggie Sink at Island*

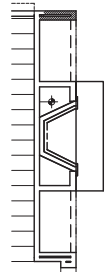

*Fireplace at Family Room*

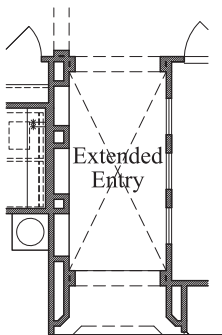

*Groin Vault Ceiling at Extended Entry*

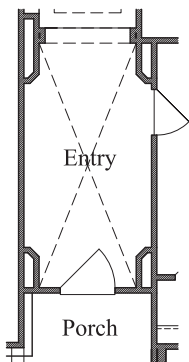

*Groin Vault Ceiling at Entry*

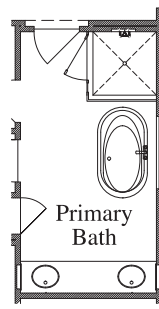

*42 x 42" Mudset Shower w/ Stand Alone Tub at Primary Bath*

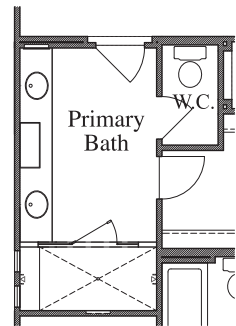

*42 x 90" Mudset Shower at Primary Bath*

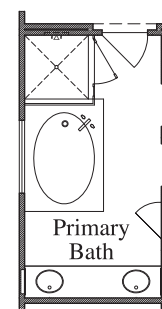

*42 x 42" Mudset Shower with Drop In Tub at Primary Bath*



**TEXAS HOMES**

Texas Built • Texas Owned • Texas Proud

TEXAS-HOMES.COM

Floorplans and elevations are an artist's rendering for illustrative purposes only and may not accurately reflect the construction plans or final product. Texas Homes reserves the right to make changes in the plans, specifications, and to substitute materials of similar quality. Floor plans, dimensions, features, options, elevations, square footages, specifications, materials and availability of homes within a neighborhood are all subject to change without notice or obligation. Prospective buyers should consult with a Texas Homes Sales Counselor for more information.



REV. 08.06.25